

# Production Booklet

for

## O'NEIL SPA



2800 Richter Ave. Suite C, Oroville, CA 95965 • **voice:** (530)534-9910

**email:** [jim@tiledspas.com](mailto:jim@tiledspas.com) • **website:** [www.tiledspas.com](http://www.tiledspas.com)

# RECOMMENDED MAINTENANCE

## *Please Note:*

These are only recommended guidelines to care for a Nespa all tiled spa. Local codes may require additional procedures, therefore consult with a pool professional that is LA county Health Department certified for more information on local codes and requirements.

## *SPA SURFACE*

Your spa tile is acid resistant and frost-proof. The Tile does not absorb germs or algae. Tile does not stain and is very easy to clean. Color does not fade or lose its luster. All grouts are epoxy based and are extremely durable. To remove scum line use soft nylon brush and small amounts of biodegradable soaps. Do not use abrasive brushes or chemicals.

## *MAINTENANCE*

---

### **A. CHEMICALS:**

- 1) It is important to maintain a chlorine residual of 2 PPM in the spa. That residual can be provided by chlorine or bromine.
- 2) It is recommended to use Bromine or dichlor (granular) forms of chlorine. If bromine Tabs are used we suggest floating or inline dispenser.
- 3) Never use acid to lower Ph in the tile spa.
- 4) Never use trichlor chlorine (1" or 3") tablets in the Nespa spas.
- 5) Never place tablets in skimmer basket.

### **B. DRAINING THE SPA:**

- 1) It is recommended to drain the spa at least once every 2 months depending on bath load and water clarity.
- 2) The spa should be drained through valve exiting re-circulation pump in the spa equipment room or sump pump.
- 3) Note: Use caution to drain spa in the winter months or rainy season when water table is at its highest. It is possible for the spa to float due to hydraulic pressure from surrounding water table. We advise that you consult with your local spa specialist prior to draining the spa.

### **C. SPA EQUIPMENT:**

- 1) Clean filter cartridge at least once every month, or when needed; i.e., if water clarity does not improve after several days.
- 2) Keep area free and clear from leaves and debris build-up.
- 3) Keep area free and clear from flooding.

### **D. SPA LIGHT:**

- 1) Spa light has to be on GFCI circuit. It is controlled at spa side with ON/OFF.

### **E. TILE SERVICING:**

- 1) Contact manufacture when servicing tile or grout. @ (530) 534-9910

## NESPA DRAWING SET

## PLAN APPROVAL DOCUMENTATION

Nespa's design and structural manufacturing departments may find it necessary to make slight adjustments (< 1") to your spa.

This may include the size of the spa (OD/ID), tile cuts, depths, jet location, bench steps etc. These adjustments must be made in the primary stages of building the spa.

The adjustments are generally made to ad structural and aesthetic integrity to the vessel. IE: balance of supporting gussets (exterior) and less tile cuts / symmetrical cuts, grout lines, etc. (interior)

**Please initial next to the following number that describes your project needs.**

- \_\_\_\_\_ 1. **YES**, I understand adjustments need to be made. Nespa will use their expertise to make these adjustments as needed.  
I give them the authority to make changes.  
I will receive final accurate drawings prior to receipt of spa or spa hole construction (if changes were made to the size)
- \_\_\_\_\_ 2. **NO**, No changes can be made even under 1". Dimensions are fixed.  
More tile cuts may be needed. Structural supports may be altered to accommodate.
- \_\_\_\_\_ 3. **Nespa** will need to contact us for any changes to spa dimensions prior to continued spa fabrication.

## APPROVAL

Purchaser is to provide protection to spa finish as well as plumbing during the installation phase. This includes rain, freeze and sun exposure.

Purchaser acknowledges that all previous drawings to this one submitted or discussed no longer apply. Purchaser accepts that all dimensions external to the Nespa product are purchaser's responsibility and that purchaser is responsible for the merging of Nespa product to job site conditions, all required dimensions and elevations and mechanical access. Purchaser also acknowledges that they are responsible for all code compliancy to the Nespa product.

Purchaser acknowledges that maintaining the spa level is critical. Purchaser will provide a level concrete platform surface for spa to sit upon. If shimming material is used purchaser will provide rigid non-compressible material.

**I approve the above drawings :**

\_\_\_\_\_ **Date:** \_\_\_\_\_

Any changes to these plans from here forward shall be directed in writing to Nespa.

0

COVER PAGE

ONEIL

SCALE: N/A



**NESPA ENTERPRISES INC.**

10/24/2022

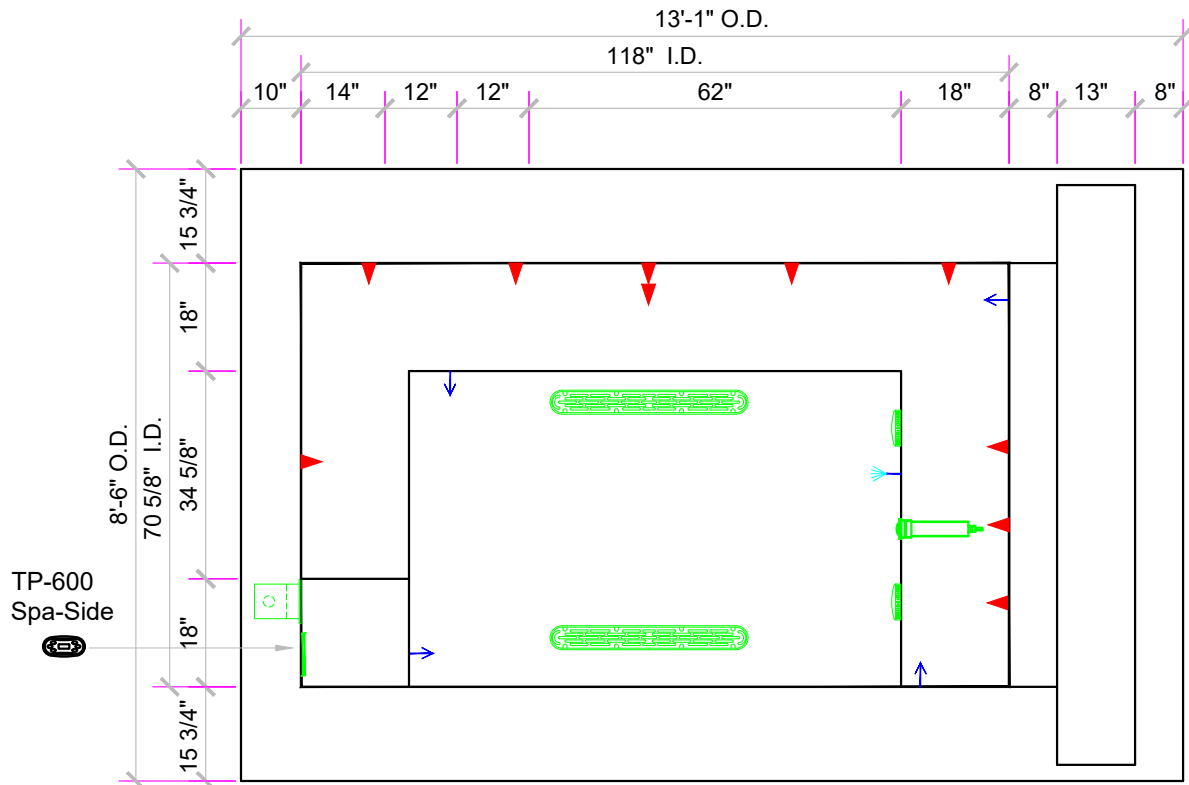

SPECIFICATIONS	
SHELL WEIGHT:	4000 LBS.
WATER WEIGHT:	9692 LBS.
TOTAL SHELL & WATER WEIGHT:	13691.8 LBS.
WATER VOLUME:	155 Cu.Ft.
WATER GALLONS:	1163 GAL.
SURFACE AREA:	57.9 SQ. FT.
ICC ES LISTED #:	PMG-1161

CODE	EQUIPMENT	DESCRIPTION	QTY.
SS		SKIMMER	1
BS		JET SUCTION	2
MD		MAIN DRAIN	2
J#		JETS	10
WI		RETURNS	4
UL		RGB - Multi Colored LIGHT	1
PB		BOND	1
SC		SPA CONTROL	1

**AUTO COVER**  
**COLOR:**  
**Charcoal**

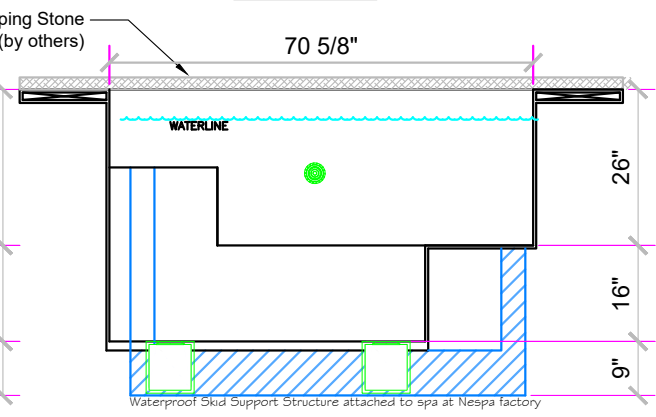
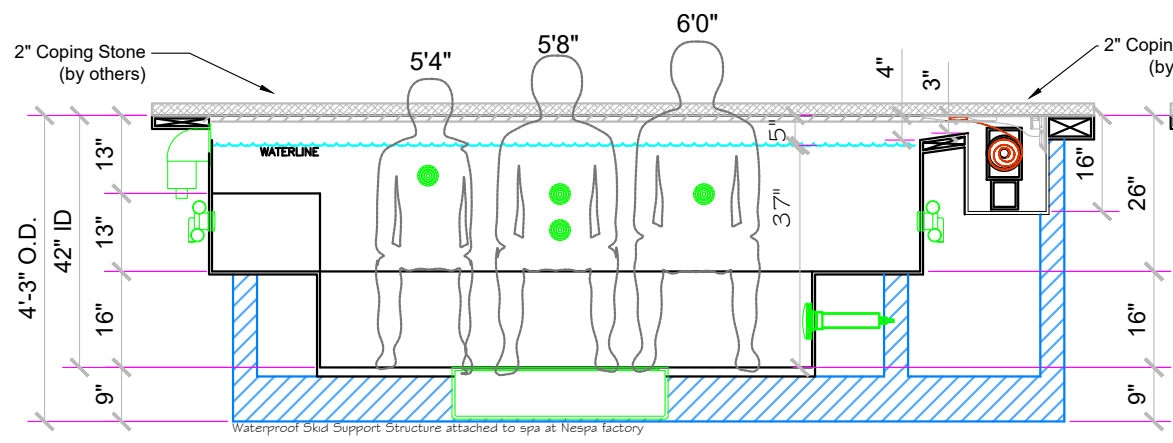

**1**  
 SD

**ONEIL**  
 SCALE: 3/8" = 1'

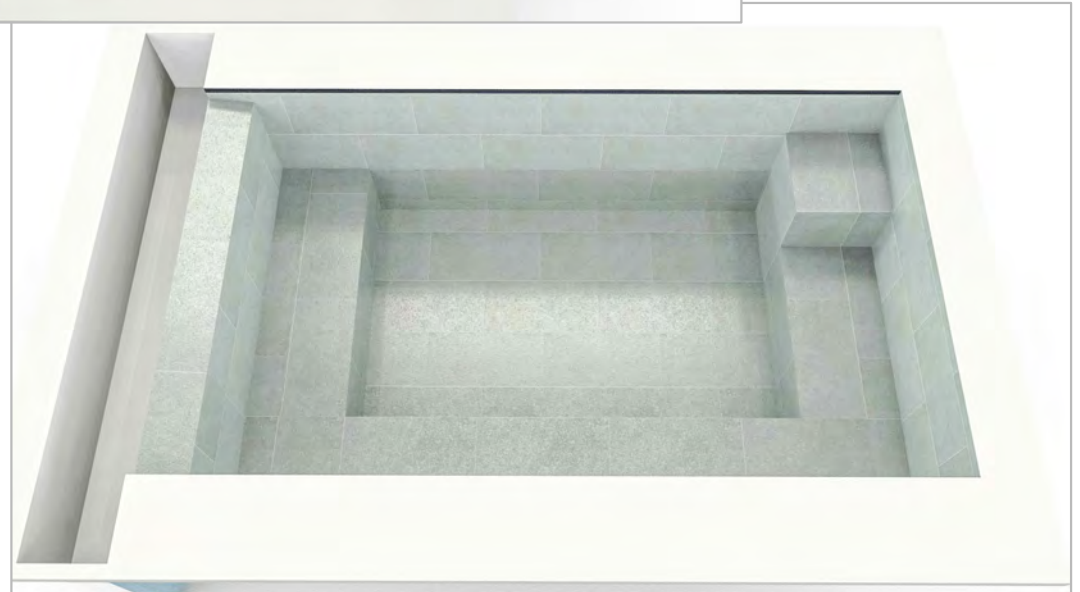
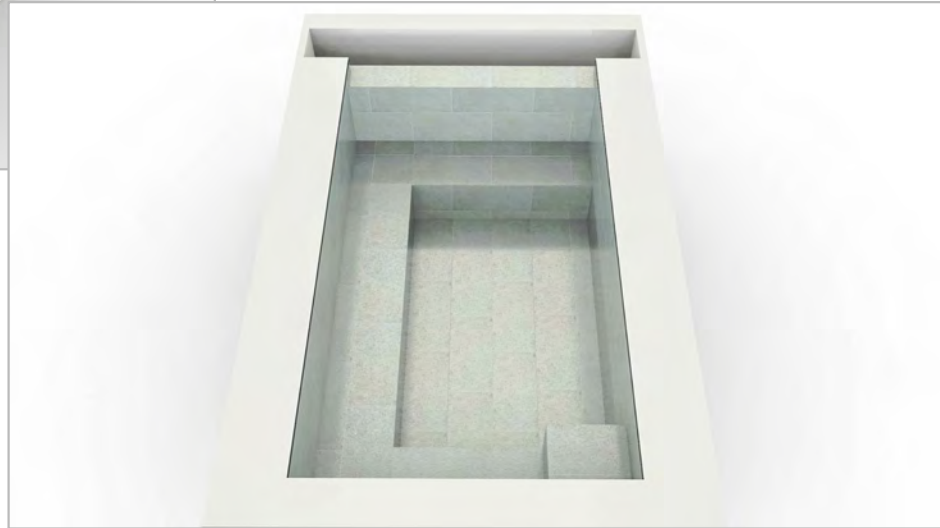
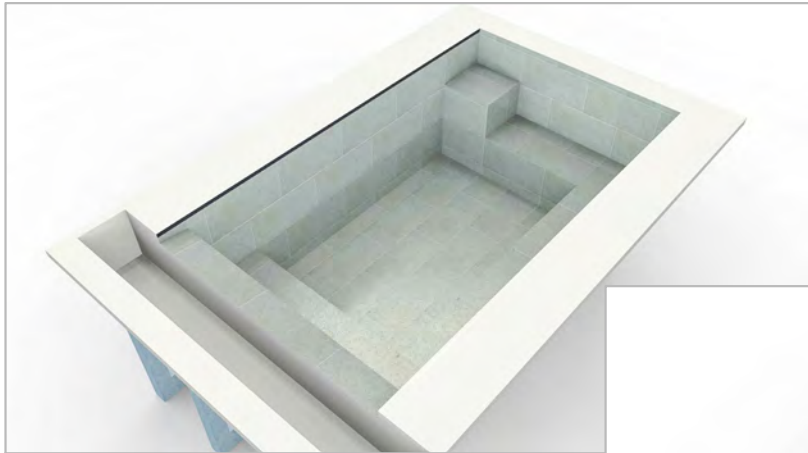

Crossville Inc Tile -  
Clean Slate -  
Grey over Blue -  
12 X 24 -  
Running Bond

2
TILE

ONEIL  
SCALE: N/A



NESPA ENTERPRISES INC.

10/29/2022



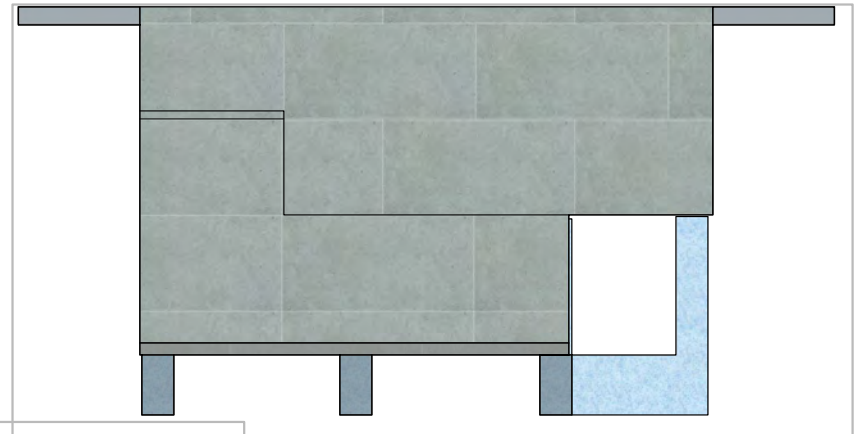
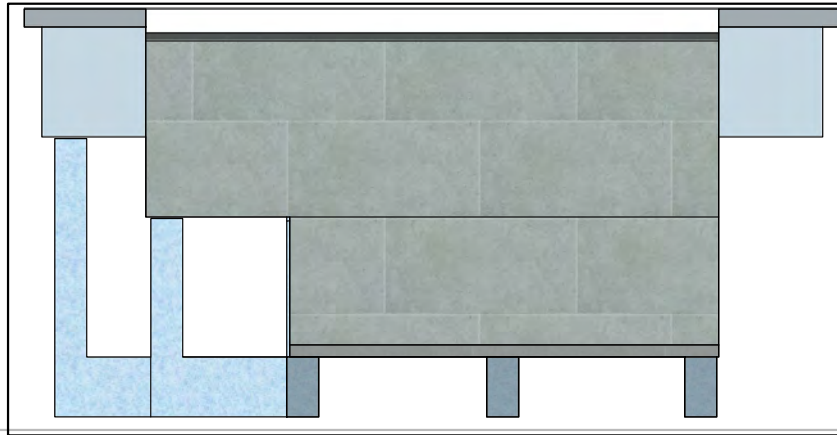

2A  
TILE (2)

ONEIL  
SCALE: N/A



NESPA ENTERPRISES INC.

10/29/2022

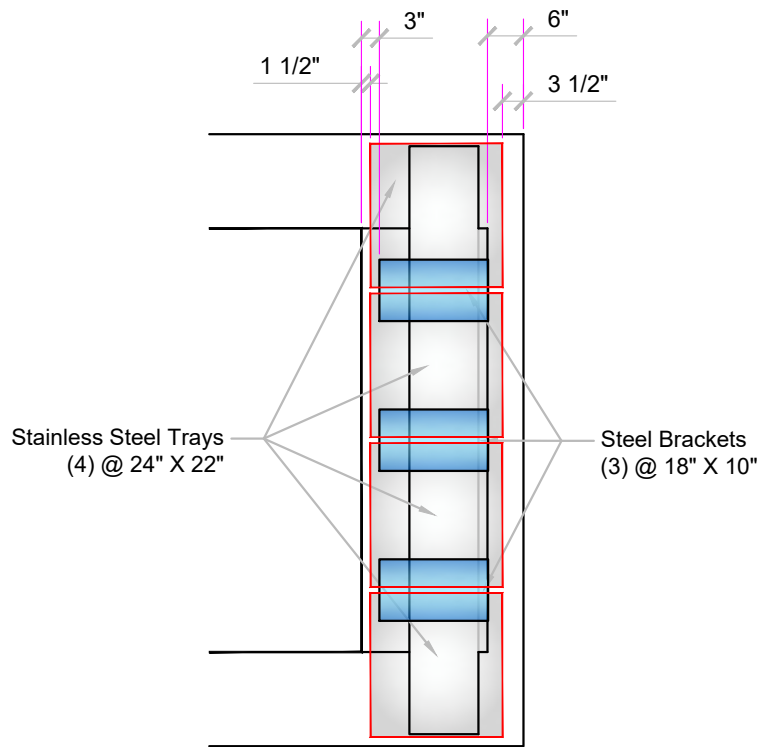

**TRAYS**

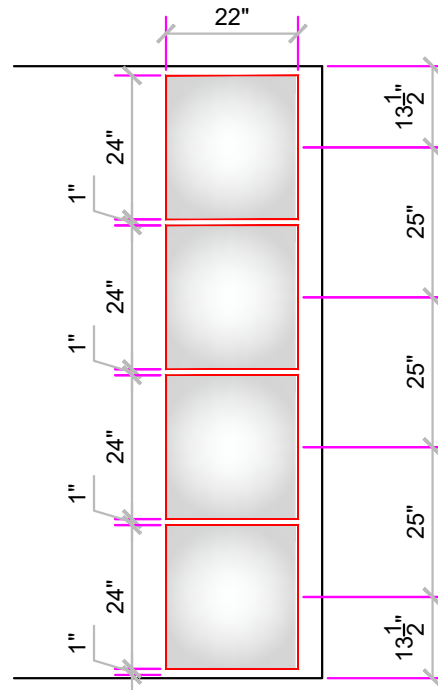

**BRACKETS**

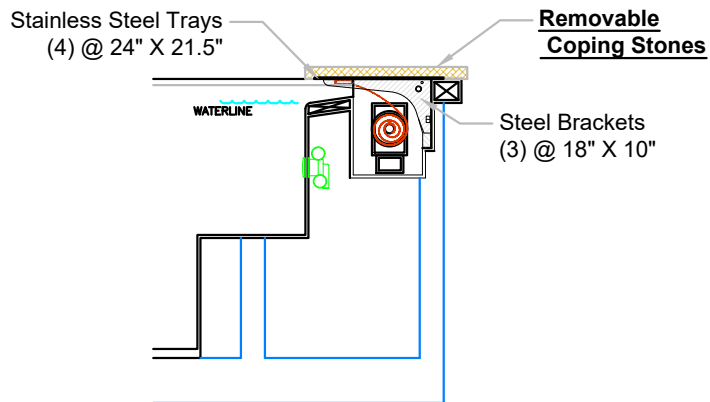
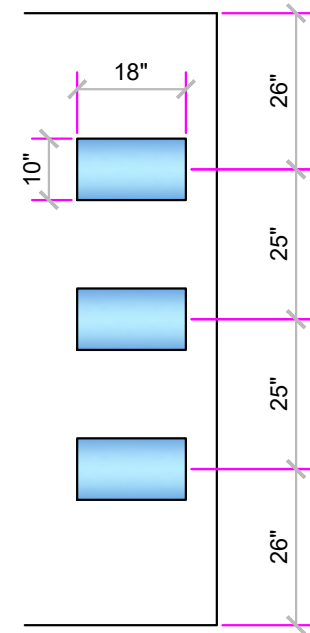

AUTO COVER  
COLOR:  
**CHARCOAL**

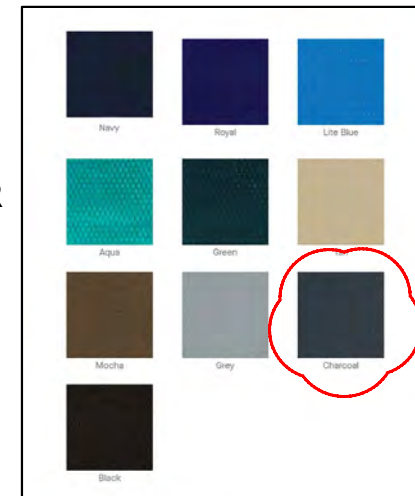

3

AUTO COVER

ONEIL

SCALE: 3/8" = 1'



NESPA ENTERPRISES INC.

10/29/2022

# STANDARD NESPA ABOVE GROUND INSTALLATION INSTRUCTIONS SET-UP AND PREPARATION

**Prerequisites:** Before installing your Nespa spa. You may be required to acquire a permit from your local State, County, and City Building Departments and or Health Department. (Commercial jobs need Health Dept. Approval). Your spa installation must comply with the most current codes. (**International Swimming Pool, Spas & Hot Tub Code 2021 (ISPSC 2021)**).

**Spa drawings:** Nespa Tiled Spas provides current spa specific construction details only. Spa plan, sections, Tile specification, spa plumbing detail. Each project has its own submittal drawings pertaining to spa vessel and plumbing only. Nespa vessels are free standing and supporting. No exterior lateral support is required. All building structural support for spa is by others. Do not rely on any website posted model. (Possibly outdated or custom)

**Delivery Access:** Clearly determine the method of getting the spa to jobsite and into the hole. This may require the use of a crane, forklift, hoist, backhoe and/or manpower etc. Each spa arrives with Spa lifting bolts for crane or rigging connections. This connection point is provided for crane or rigging connection. These eyebolts are removable after delivery.

ABOVE-GROUND The following instructions are general guidelines and may not apply to your specific jobsite conditions. Owner/Contractor to provide spa support structure capable of supporting spa load /weight with water and people. Owner/contractor all plumbing, electrical, control electrical and light connection clearances as required by code. This 10” clearance is to accommodate jet and suction plumbing. This 10” clearance can change or be reduced upon request. Note: skimmer location, this area may have to be larger than 10”, if commercial 22”.

- 1) **Freeze Climates-** If the spa is to be installed into a vault (typical of freeze climates) a standard clearance from vault wall to wall of spa should be 24” or more. If limited space is available contact Nespa for options. This area around spa is for possible future access to spa plumbing in case of a freeze. Area drain or sump pump in vault is mandatory. **Ask your local installer** for his experienced opinion. Do not hesitate to call us because we want to be sure that your installation progresses as smoothly as possible. If you have questions call us. (530) 534-9910.
- 2) **Hole depth** is determined by spa’s outside height dimension. This height may vary depending on if spa has skids or no skids. The spa lip may be finished or non-finished. How is the perimeter deck elevation transitioning to the spa? Focus on the finish surrounding deck elevations, thickness of the finish material on spa upper horizontal lip, equal to lip or under the spa lip. This material can be tile, stone, concrete or brick.
- 3) **Pre-plumb:** Nespa factory installs all fittings, suctions and jets into spa before it goes into the hole. All vessels are factory water tested and plumbing is tested for 48 hours. If there are needs for electrical, bonding or control conduits run them as well before dropping in hole. Connecting a bond wire to the niche would be best practice.
- 4) **Support Pad:** Spa should sit on surface engineered to support the weight of vessel with water and people. Others to provide a level support platform. Support platform design and engineering is the responsibility of owner/contractor. Sweep debris off landing area prior to dropping in hole.
- 5) **Install spa** into the hole on top of support platform. Use the factory support lifting eye bolts provided for



crane, forklift rigging etc. Do not hold onto pipes. Use caution with suction and jet plumbing when lowering into hole. **DO NOT STRESS FITTINGS!** Fill Spa with water and check for leaks prior to backfill.

- 6) **Check site reference** points for proper spa positioning (i.e., squaring to house, garage, etc.).
- 7) **Shim to level spa.** Shim with non-compressible material. Re-square to house, or ref. point.
- 8) **Dry pack under spa support skids**, with cement, the gaps that have been created when shimming spa level.
- 9) **Connect pipes to tees** if spa is pre-plumbed. Installers should properly support your new plumbing from stressing the spas pre-plumbed fittings. After electrical conduit and bond wire is connected to light niche, water test spa before back filling with sand.

**NOTE: All Nespa products are water tested prior to leaving factory.**

### **ELECTRICAL:**

- 1) All electrical connections to spa or equipment shall comply with the most recent national electrical code (NEC), state and local codes.
- 2) Connect electrical conduit to light niche. This work shall be done or reviewed by a licensed electrician.
- 3) To install a spa light you will need to include, inside the PVC conduit to the light niche, a solid #8 coated copper wire. (If you are using brass conduit, internal bond wire is not required.) This bond wire should be pulled with the light cord at the same time. This bond wire needs to be attached to the internal bonding lug of the light niche. An approved encapsulate should be applied to bond wire connection in niche.
- 4) An external #8 copper wire shall be connected to the external bonding lug on the rear of the light niche. This copper wire can then be used for additional bonding requirements (i.e., handrails or any other metallic object within 5' of the spa).

### **PLUMBING:**

- 1) When plumbing a Nespa it is important to properly size the plumbing. We highly recommend that you follow the pump manufacturer's pipe sizing requirements and International Swimming Pool, Spas & Hot Tub Code 2021 (ISCSP 2021).
- 2) We recommend that you consult a pool professional to specify spa plumbing hydraulics.
- 3) The Nespa shells are water tested and pressure tested prior to shipping.
- 4) All plumbing inground or exterior to spa shell should be pressure tested at 35 psi (one hour minimum).
- 5) Fill spa with water and test the system for leaks.

### **WATERPROOFING**

- 1) Waterproofing is the responsibility of owner/contractor. Waterproof Spa Vault or containment structure to have area drain. Nespa does not provide waterproof guidelines, we recommend that owner hires waterproof professionals.
- 2) If spa is free standing on elevated deck or a structure, it is important to fill spa with water and load area prior to installing coping or perimeter decking. If spa is installed in a vault situation an area drain is needed.

## **NESPA ENTERPRISES, Inc. LIMITED WARRANTY**

**This LIMITED WARRANTY covering NESPA products is extended to the ORIGINAL PURCHASER-USER BY NESPA ENTERPRISES Inc.(NESPA), 2800 Richter Ave. Unit C California 95966.**

**NESPA products are thoroughly inspected and tested prior to factory shipment. NESPA warrants to the ORIGINAL PURCHASER-USER that NESPA Spas and Pools will be free of defect in workmanship, accessories, and parts, provided said accessories and parts were manufactured by NESPA. NESPA, under this LIMITED WARRANTY, warrants only that its Spas and Pools shall be structurally sound, shall retain their shape, and shall retain water for the warranty period. NESPA warrants the adhesion of tile to fiberglass for a period of two (2) years (salt systems 1 year) and structural soundness for fifteen (15) years. NESPA warrants epoxy grout adhesion for a period of three (3) years. NESPA warrants factory installed plumbing for a period of two (2) years. If any such defects appear and are reported within the warranty period, NESPA shall repair or replace such defective parts without charge if an inspection proves the claim. All materials provided to Nespa and installed ie; tile, grout, lights, control center, spa side controls, pumps, and Equipment packs are warranted by the original manufacturer for one year.**

**The provisions of the LIMITED WARRANTY shall not apply to tile cracked, split, chipped or damaged after the product has left the factory, nor damage to tile caused by freezing nor to damage, defect, malfunction or failure to conform with the above warranty provisions where the damage, defect, malfunction or failure to conform was caused during shipment/delivery or by distributor or by unreasonable use or storage during construction by ORIGINAL PURCHASER-USER including improper water balance, cleaning, water or electrical supply to spa or surface and plumbing protection.**

**This LIMITED WARRANTY shall not apply to any plumbing, equipment, or installation of Spas and Pools and shall not apply to any alterations made to or upon NESPA products except alterations made by NESPA employees or NESPA authorized representatives.**

**This LIMITED WARRANTY is expressly in lieu of all other warranties expressed or implied including the warranties of merchantability and fitness for use and all other obligations or liabilities on NESPA'S part, and NESPA neither assumes nor authorizes any other person to assume for NESPA any other liability in connection with the sale of this NESPA product. This LIMITED WARRANTY shall not apply to this NESPA product or any part thereof which has been subject to accident, negligence, alteration, abuse or misuse. NESPA makes no warranty whatsoever with respect to accessories or parts not manufactured by NESPA.**

**The term "ORIGINAL PURCHASER-USER" as used in this LIMITED WARRANTY shall be deemed to mean that person for whom the NESPA product is originally installed.**

**The LIMITED WARRANTY provided herein and the obligations and liabilities of NESPA hereunder are exclusive and are in lieu of, and buyer and original PURCHASE-USER hereby waive all other remedies, warranties, guarantees or liabilities, expressed or implied, arising by law or otherwise (including without limitation and obligations of NESPA with respect to fitness, merchantability, and consequential damages) or whether or not occasioned by NESPA'S negligence.**

**This LIMITED WARRANTY shall not be extended, altered or varied except by a written instrument signed by NESPA and original PURCHASER-USER.**